

Find us

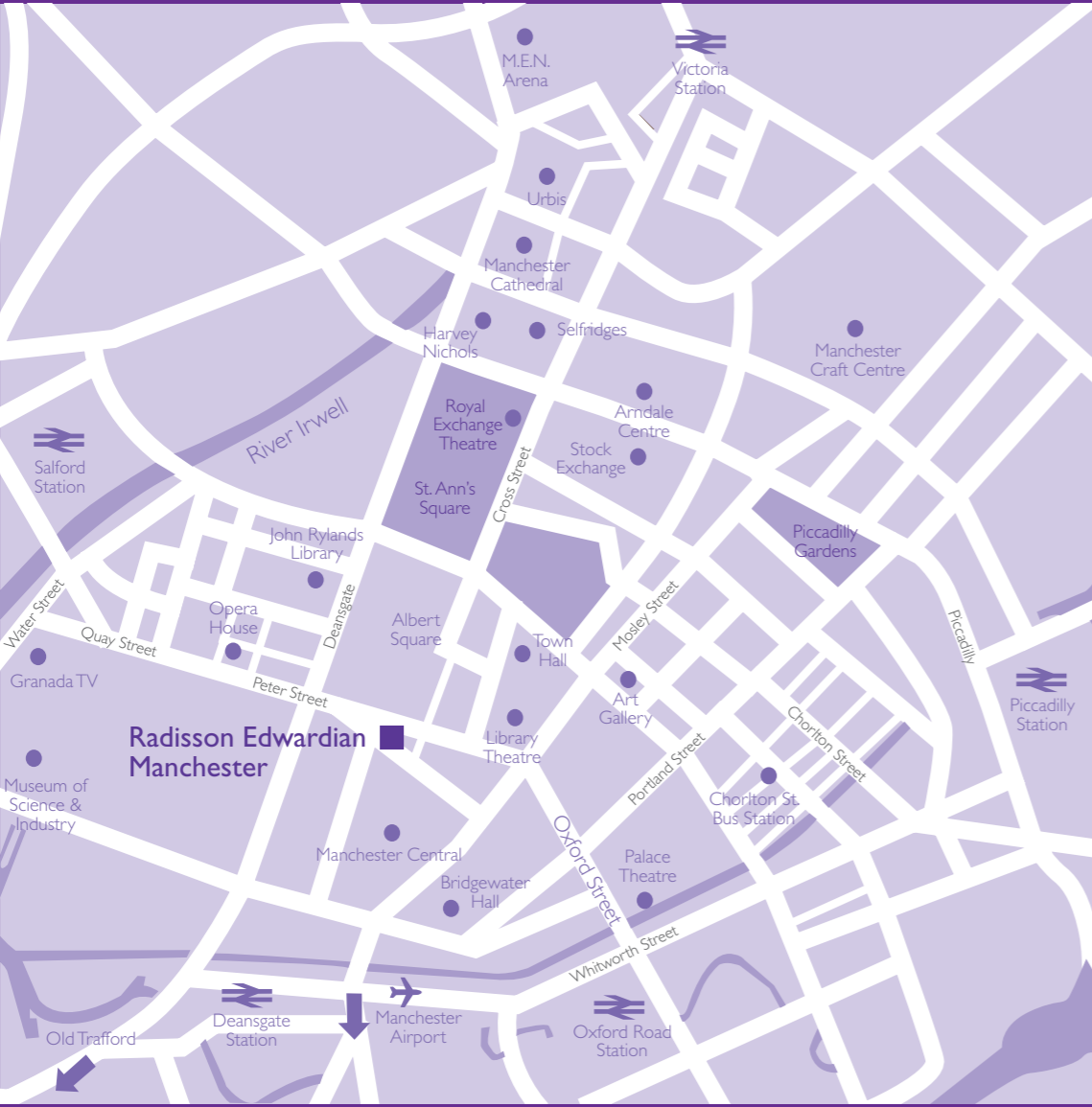

Meetings and Events

at the Radisson Edwardian Manchester

Radisson Edwardian Manchester ★★★★★ Free Trade Hall, Peter Street, Manchester M2 5GP
 t: +44 (0)161 835 8931 f: +44 (0)161 835 8937 e: rehmanchestermeetings@radisson.com
radissonedwardian.com/manchester

MAN/CB/02.11

Our experience creates a better experience





Meetings and events should always be this easy

- Flexible spaces
- Dedicated consultants
- Complimentary wi-fi
- Food that's fast, fresh and healthy
- Sensible pricing without the hidden extras
- All-inclusive small meeting packages
- Loyalty rewarded with Points for Planners
radissonedwardian.com/pointsforplanners

Meet Well

Meeting well means treating well the things that really matter. More than just reducing your meeting's environmental impact, it's also a commitment to positively affecting the communities we are a part of. Our approach to responsible business means a clearer conscience for you – whatever the size and style of your event.

Visit radissonedwardian.com/meetwell





In Manchester's most celebrated building, the Free Trade Hall, stylish spaces create a mood of understated luxury just moments from Manchester Central. 18 flexible meeting rooms host events for up to 280. Sienna Spa, deep in the building's vaults, is a blissful urban hideaway, and Opus One bar and restaurant showcases the season's best British ingredients. Through the hotel's soaring lobby, Alto is a relaxed alternative for dress-down dining.

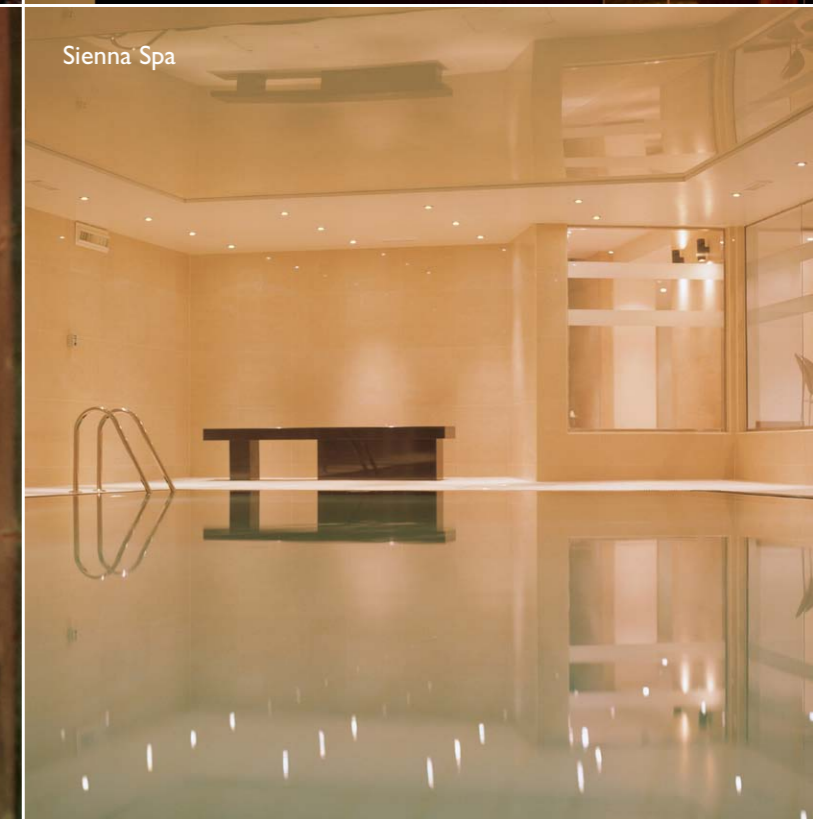
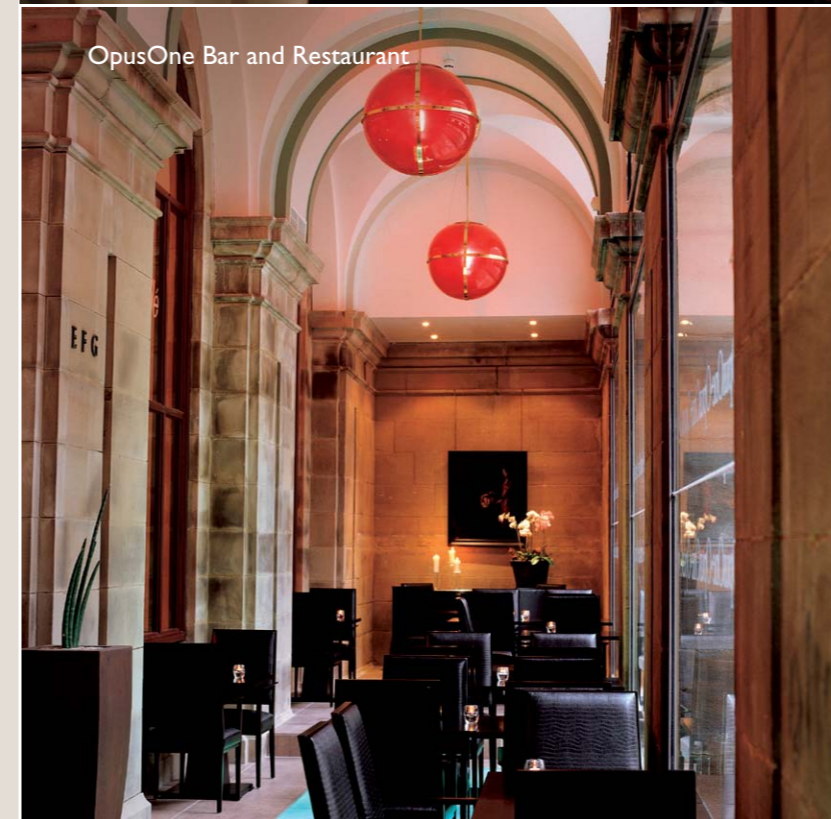

Thought for food

There's truth in the old adage that you are what you eat, so it's reassuring to know that considerable thought has gone into preparing it.



A mid-morning energy boost, lunch to linger over and a well timed afternoon pick-me-up – it's all freshly prepared and nutritionally balanced to help you stay sharp throughout the day, because the food you eat fuels your success.

Opt for a bespoke menu tailored to your needs, or select from three mouth-watering menu options designed for meetings and events of every size and style.



Capacity

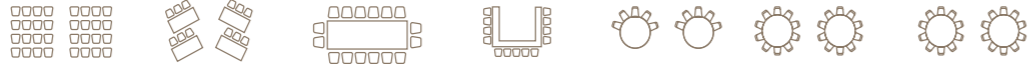

	Theatre	Classroom	Boardroom	U-shape	Cabaret	Reception	Lunch/Dinner
Halle Suite	400	180	80	90	200	500	280
Richter	120	50	30	30	54	100	80
Beecham	60	24	20	–	24	50	30
Harty	60	24	20	–	24	50	30
Barbirolli	120	50	30	90	54	125	80
Walters Suite	80	50	32	36	50	70	70
Peterloo	–	–	16	–	–	–	16
Hunt	–	–	16	–	–	–	16
Bamford	–	–	16	–	–	–	16
Cobden	–	–	16	–	–	–	–
Bright	–	–	12	–	–	–	–
Villiers	–	–	12	–	–	–	–
Peel	30	16	16	20	12	30	20
Disraeli	30	16	16	20	12	30	20
Gladstone	30	16	14	14	12	30	20
Dickens/Thackeray	80	40	36	30	36	60	60
Dickens	50	30	16	1	18	30	30
Thackeray	30	16	14	12	12	20	20
Pankhurst	60	24	36	–	18	80	40
Stanley/Livingstone	100	50	40	36	54	80	80
Stanley	50	26	20	20	24	40	40
Livingstone	40	18	14	14	12	20	20
Kenney	–	9	10	–	–	–	10
Mursell	–	9	10	–	–	–	10
Collier	–	9	10	–	–	–	10

Floor Dimensions

	Area	Length m (ft)	Width m (ft)	Height m (ft)	Floor	Natural daylight
Halle Suite	357 m ² (3843 sq ft)	27.5m (90'3")	13m (42'8")	3.6m (11'10")	2	✓
Richter	105 m ² (1130 ft ²)	8.1m (26'7")	13m (42'8")	3.6m (11'10")	2	✓
Beecham	62 m ² (667 ft ²)	4.8m (15'9")	13m (42'8")	3.6m (11'10")	2	✓
Harty	62 m ² (667 ft ²)	4.8m (15'9")	13m (42'8")	3.6m (11'10")	2	✓
Barbirolli	127 m ² (1367 ft ²)	9.8m (32'2")	13m (42'8")	3.6m (11'10")	2	✓
Walters Suite	36 m ² (387 ft ²)	11.6m (38')	3.6m (11'10")	2.1m (6'11")	1	✓
Peterloo	34 m ² (36 ft ²)	7.6m (24'11")	4.5m (14'9")	2.1m (6'11")	1	✓
Hunt	34 m ² (366 ft ²)	7.6m (24'11")	4.5m (14'9")	2.1m (6'11")	1	✓
Bamford	34 m ² (366 ft ²)	7.6m (24'11")	4.5m (14'9")	2.1m (6'11")	1	✓
Cobden	24 m ² (258 ft ²)	6.8m (22'4")	3.6m (11'10")	2.1m (6'11")	1	✓
Bright	24 m ² (258 ft ²)	6.8m (22'4")	3.6m (11'10")	2.1m (6'11")	1	✓
Villiers	24 m ² (258 ft ²)	6.8m (22'4")	3.6m (11'10")	2.1m (6'11")	1	✓
Peel	36 m ² (387 ft ²)	8m (26'3")	4.6m (15'1")	2.25m (7'5")	3	✓
Disraeli	36 m ² (387 ft ²)	8m (26'3")	4.6m (15'1")	2.25m (7'5")	3	✓
Gladstone	39 m ² (420 ft ²)	6.5m (21'4")	6.1m (20')	2.25m (7'5")	3	✓
Dickens/Thackeray	106 m ² (1141 ft ²)	1.4m (45'11")	7.6m (24'11")	2.25m (7'5")	4	–
Dickens	62 m ² (7 ft ²)	8.2m (26'11")	7.6m (24'11")	2.25m (7'5")	4	–
Thackeray	44 m ² (473 ft ²)	5.8m (19')	7.6m (24'11")	2.25m (7'5")	4	–
Pankhurst	88 m ² (947 ft ²)	14.7m (48'3")	6m (19'8")	2.25m (7'5")	4	–
Stanley/Livingstone	125 m ² (1345 ft ²)	13.6m (44'7")	9.2m (30'2")	2.25m (7'5")	4	–
Stanley	74 m ² (796 ft ²)	7.8m (25'7")	9.6m (31'6")	2.25m (7'5")	4	–
Livingstone	53 m ² (570 ft ²)	5.8m (19')	9.2m (30'2")	2.25m (7'5")	4	–
Kenney	28 m ² (301 ft ²)	4.8m (15'9")	6m (19'8")	2.1m (6'11")	4	–
Mursell	26 m ² (279 ft ²)	4.8m (15'9")	5.6m (18'4")	2.1m (6'11")	4	–
Collier	26 m ² (279 ft ²)	4.8m (15'9")	5.6m (18'4")	2.1m (6'11")	4	–

First Floor

All meeting rooms are fully air conditioned and benefit from:

- Complimentary wireless
- Broadband access
- Dedicated audio-visual support
- CD, DVD, VHS on request
- LCD projection, all rooms have build in screens
- Business centre with printing facilities and ATM machine

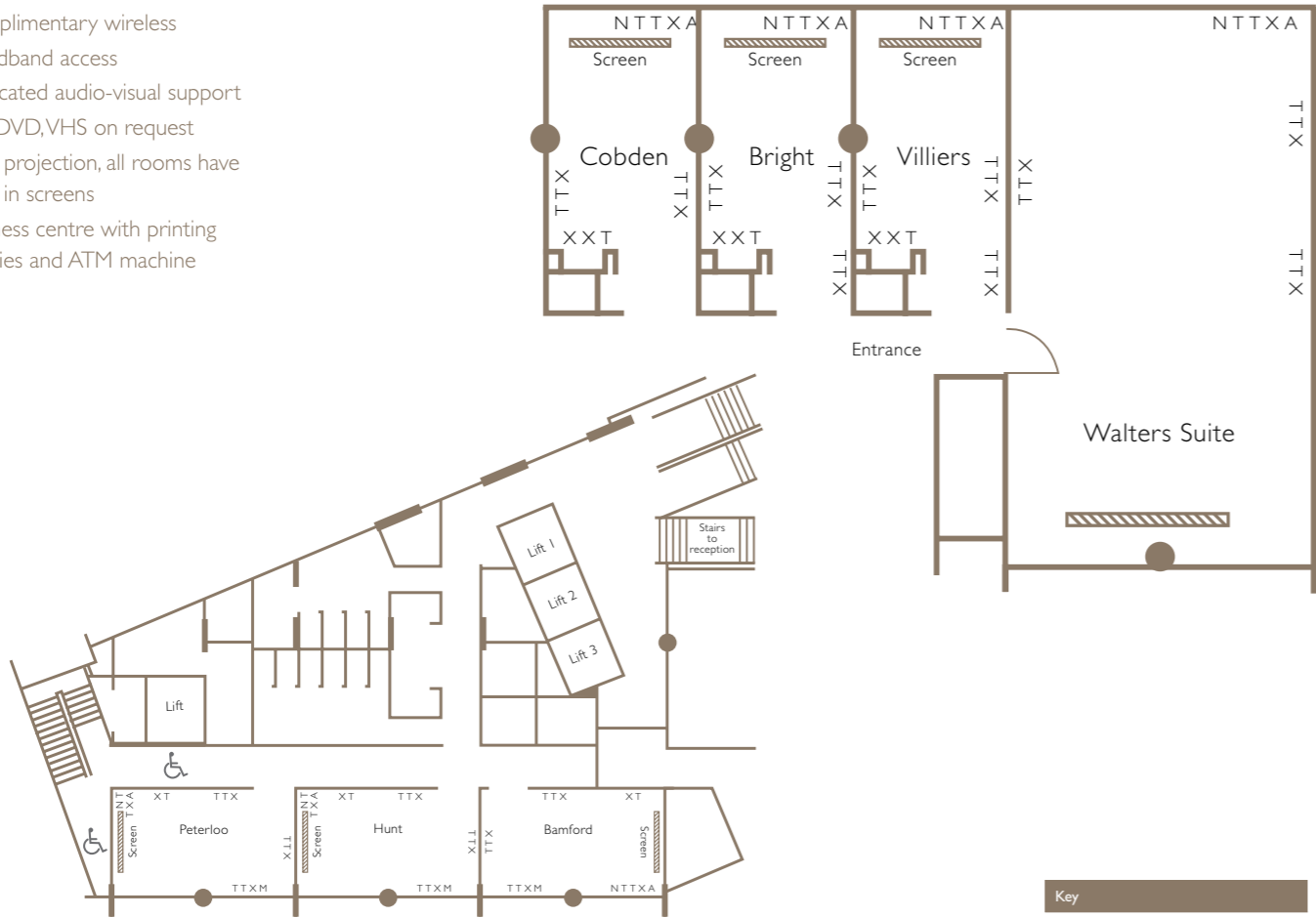

Key	
A	= TV aerial
N	= Network point
T	= Phone
X	= 13 amp socket
X	= 13 phase 63a supply
⊙	= Lighting Control Panel
▨	= Screen
■	= Partition

Second Floor: Halle Conference Centre

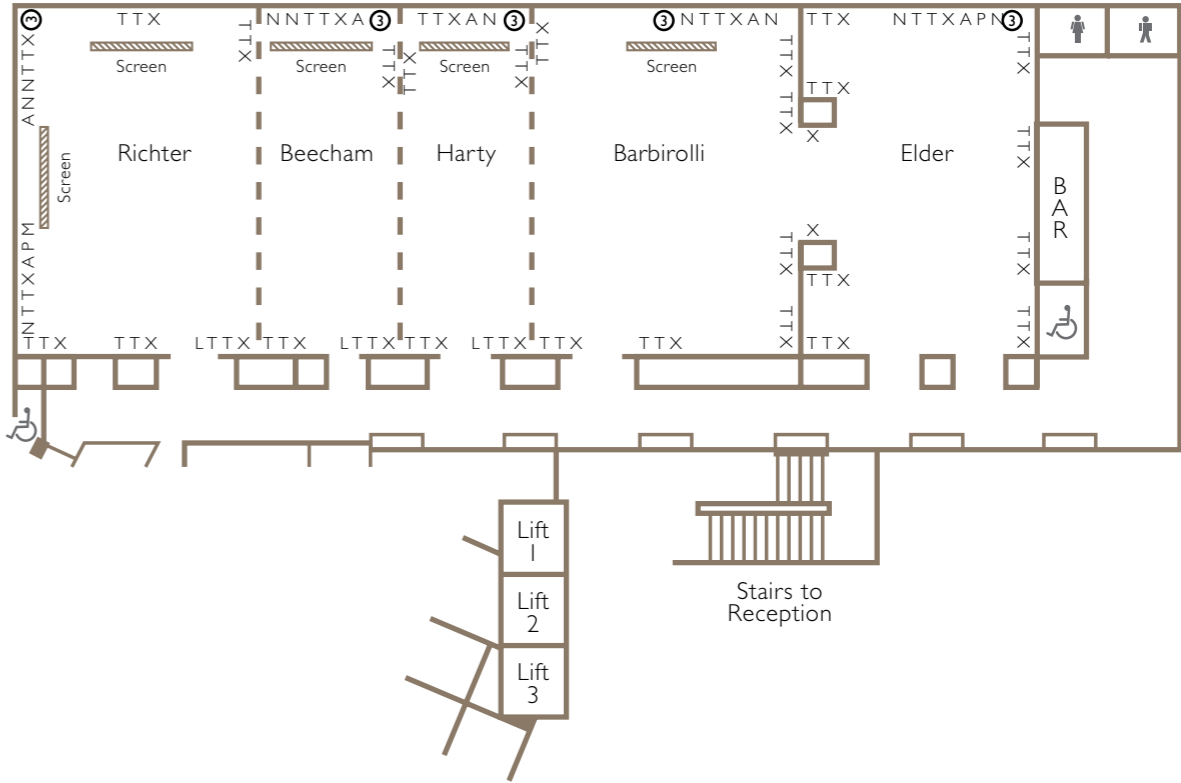

Third Floor

Fourth Floor

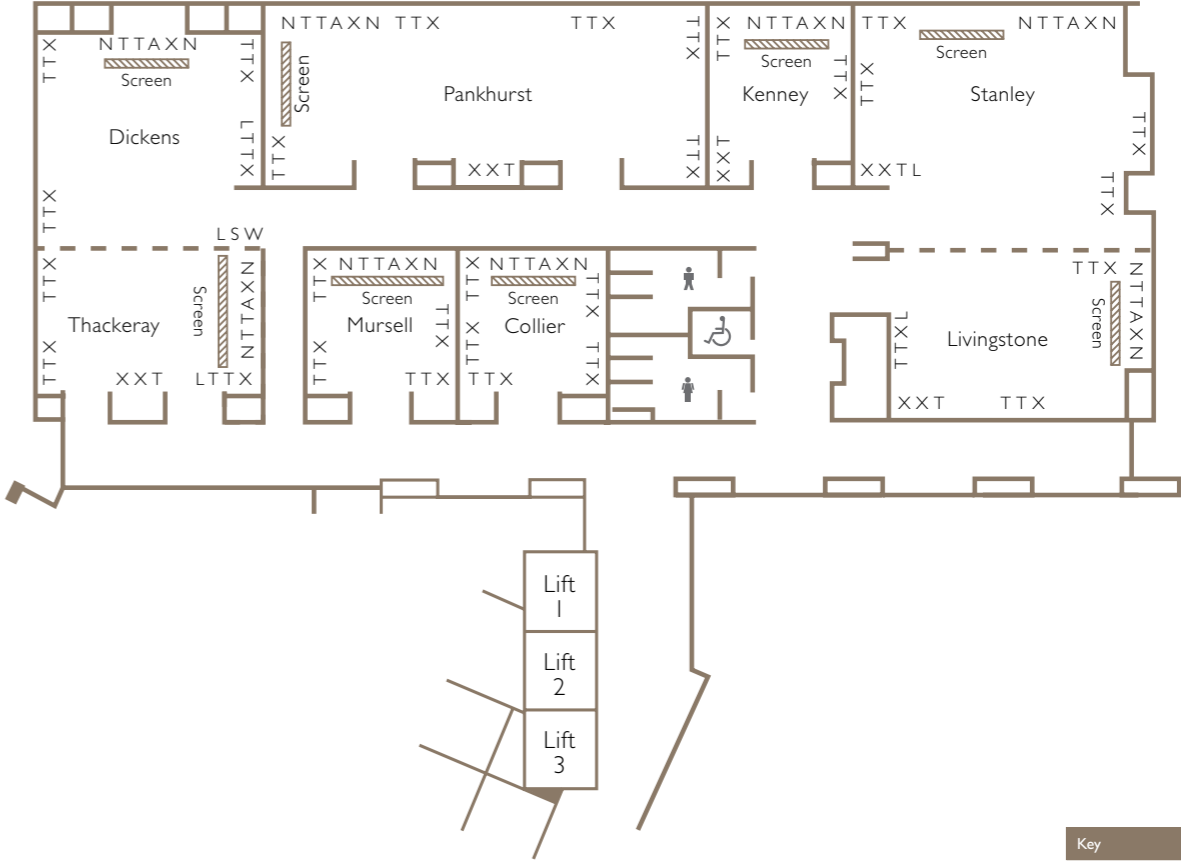
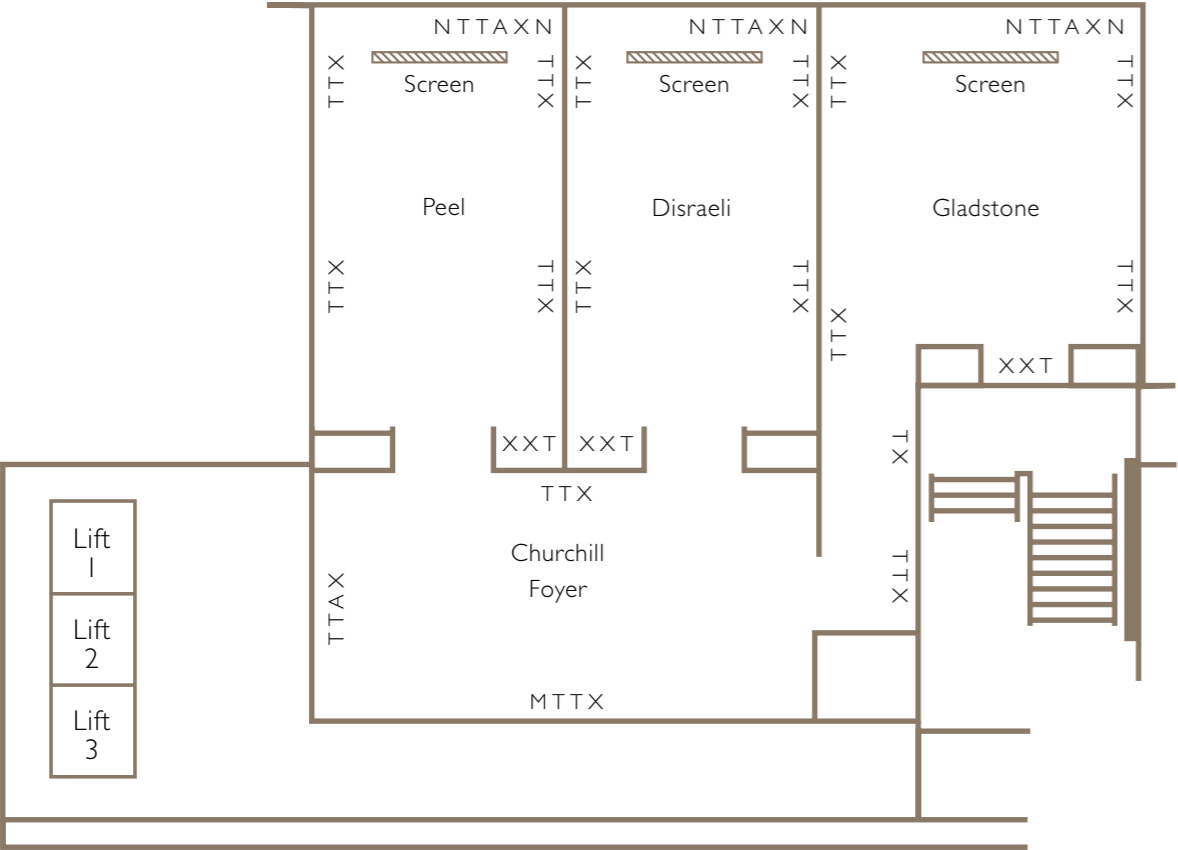

Key	
A	= TV aerial
N	= Network point
T	= Phone
X	= 13 amp socket
▨	= Screen
■	= Partition