

THE OVERVIEW

The hotel offers:

- Complimentary wireless throughout
- Access to Palm Beach Casino through main lobby (for residents and pre-bookings)
- AV manager/technician on site
- Direct phone for contact between event organiser and conference manager
- Air conditioning throughout
- Digital event signage incorporating client logo
- Disabled access throughout

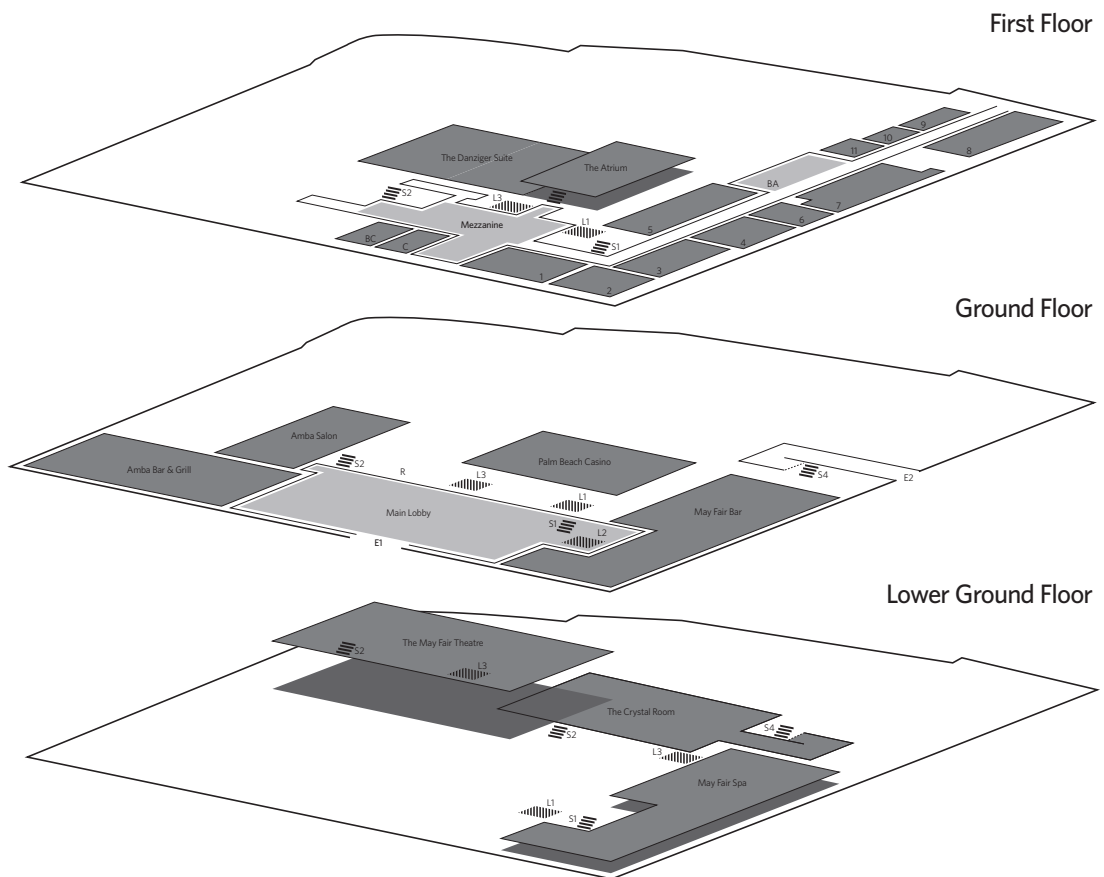

First Floor

- 1-11 Private Rooms
- BA Breakout Area
- BC Business Centre
- C Cloakroom
- L1 Lift to ground and lower ground
- S1,2 Stairs to ground and lower ground
- L3 Disabled lift to ground and lower ground

Ground Floor

- E1 Entrance from Stratton Street
- E2 Entrance from Berkeley Street
- R Reception
- L1 Lift to first, lower ground and bedrooms
- L2 Lift to all upper hotel floors
- L3 Disabled lift to first and lower ground
- S1 Stairs to May Fair Spa and first
- S2 Stairs to The May Fair Theatre and The Crystal Room
- S4 Stairs down to The Crystal Room

Lower Ground Floor

- S1,2 Stairs up to Reception and Main Lobby
- S4 Stairs up to Berkeley Street exit
- L1 Lift to ground and first
- L3 Disabled lift to ground and first

The May Fair Hotel, Stratton Street, London W1J 8LT Telephone +44 (0)20 7915 3898 Facsimile +44 (0)20 7409 7016
 Email mayfcb@radisson.com Website themayfairhotel.co.uk

GROUND FLOOR DETAIL

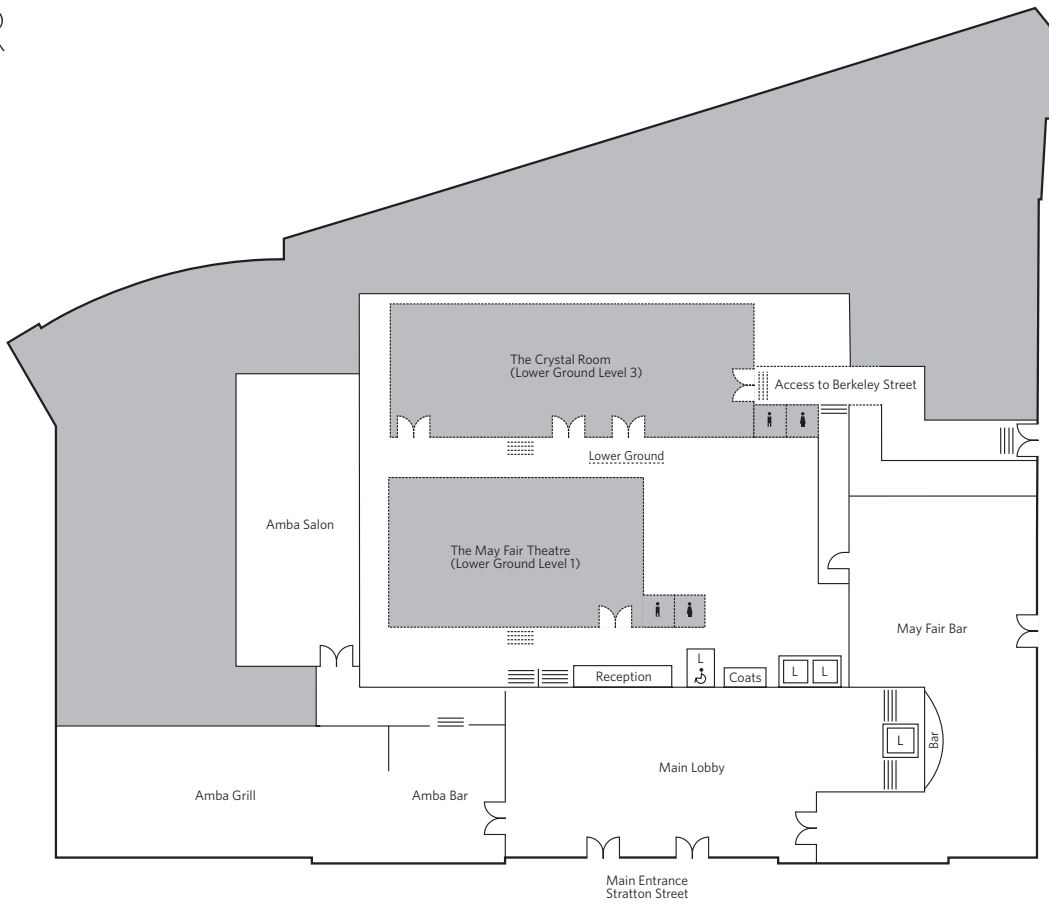

FIRST FLOOR DETAIL

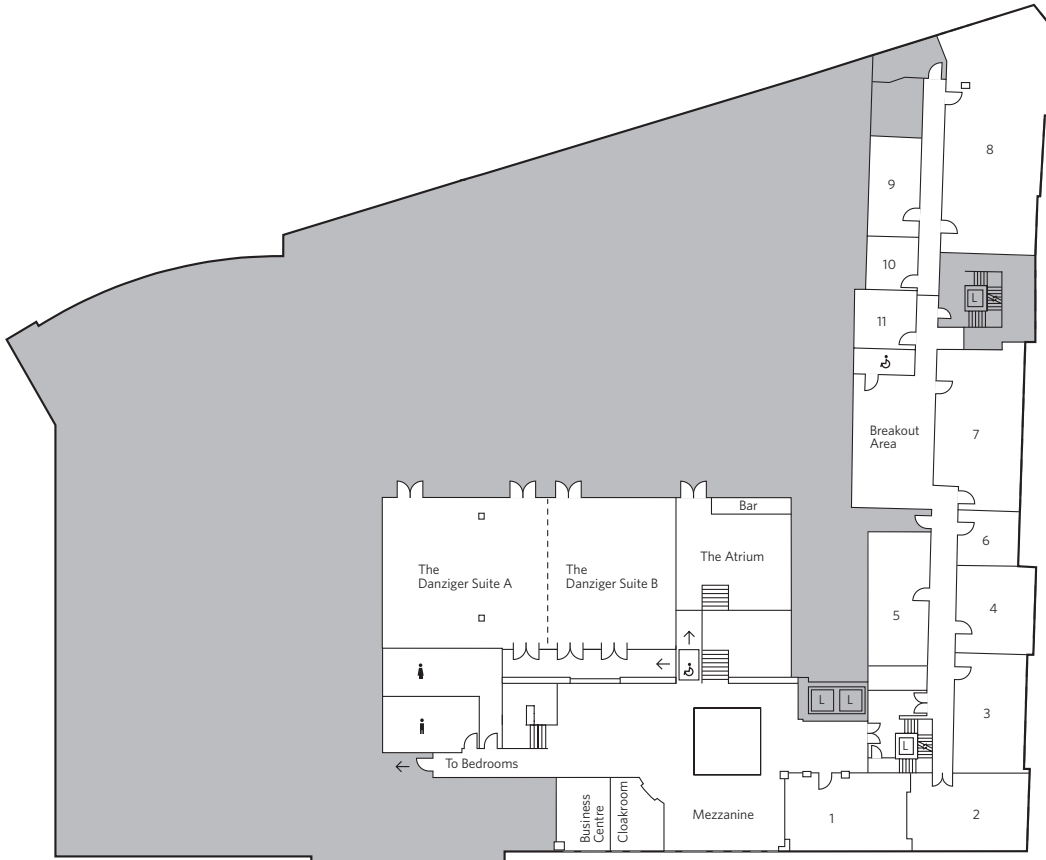

The May Fair Hotel, Stratton Street, London W1J 8LT Telephone +44 (0)20 7915 3898 Facsimile +44 (0)20 7409 7016
 Email mayfcb@radisson.com Website themayfairhotel.co.uk

THE MAY FAIR