

RADISSON AT WORK: TO MAKE YOUR MEETING OR EVENT A SUCCESS

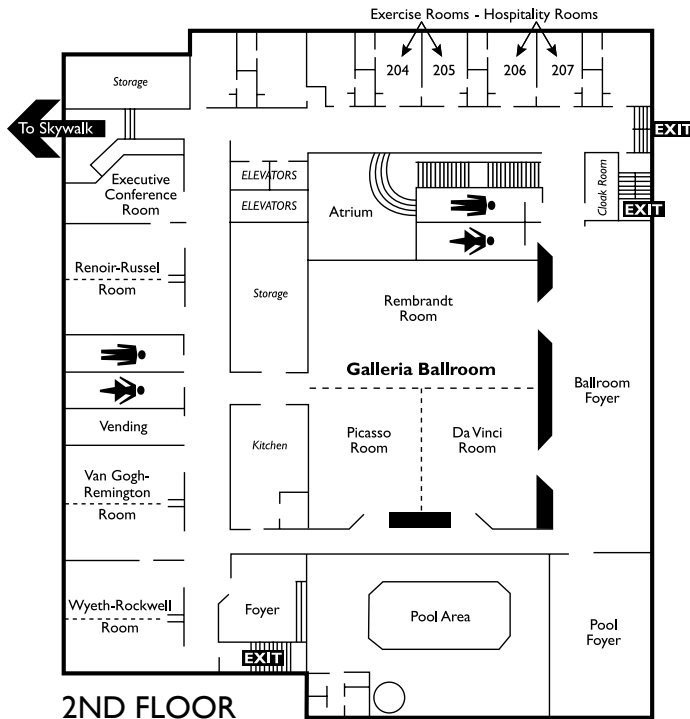

With our downtown location the Radisson Hotel Bismarck welcomes you to unmatched hospitality, superb service, and meticulous attention to guest comfort, detail, and security. The Radisson Hotel Bismarck is the perfect hotel for corporate travel and affordable group meetings as well as leisure guests.

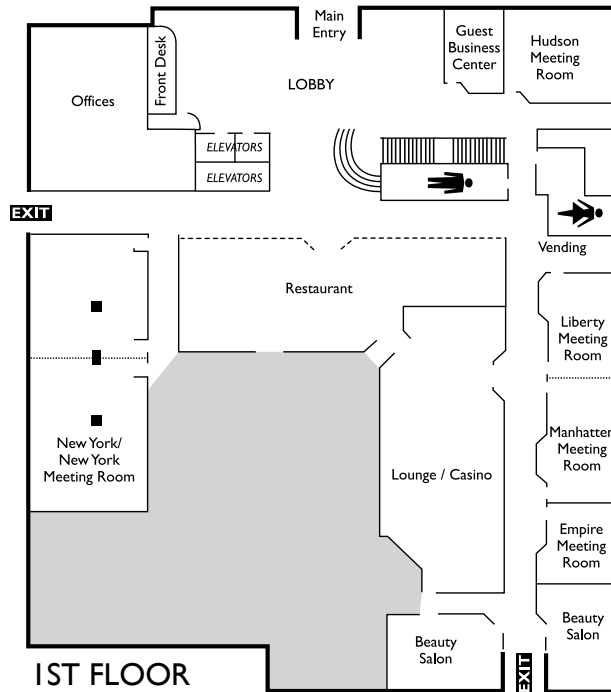

RADISSON AT WORK: TO MAKE YOUR MEETING OR EVENT A SUCCESS

BANQUET & MEETING ROOM SPECIFICATIONS

Room	Dimensions	Sq Ft	Ceiling HT	Reception	Theater	Class-room	Oval Tables	U Shape	Hollow Square	Confer-ence	Crescent Ovals
Galleria Ballroom	60' x 67'	4020	12'-14'	500	400	250	330	60	102	N/A	260
Ballroom Lobby	24' x 82'	1968	12'	240	N/A	N/A	N/A	N/A	N/A	N/A	N/A
Rembrandt	60' x 33'	1980	12'-14'	250	200	120	150	47	60	57	120
Picasso/DaVinci	60' x 33'	1980	12'-14'	250	200	120	150	47	60	57	120
Picasso	31' x 33'	1023	12'-14'	100	60	40	60	24	30	28	48
DaVinci	29' x 33'	957	12'-14'	100	60	40	60	24	30	28	48
Exec. Conf. Room	12' x 30'	360	10'	Special Board Room Table to Seat 12							
Wyeth-Rockwell*	30' x 30'	900	10'	70	70	36	60	24	32	28	48
Van Gogh-Remington*	30' x 30'	900	10'	70	70	36	60	24	32	28	48
Renoir/Russell*	30' x 30'	900	10'	70	70	36	60	24	32	28	48
Liberty/Manhattan	61' x 18'	1088			80	50	70	N/A	N/A	18	56
Manhattan	33.5' x 18'	603			40	32	30	N/A	N/A	18	24
Liberty	27.5' x 18'	486			40	20	30	N/A	N/A	16	24
Empire	20.5' x 18'	369			20	12	20	N/A	N/A	12	16
Hudson	22' x 23'	506	10'	40	40	25	40	20	16	18	32
New York/New York**	30' x 72'	2166	10'	200	150	56	150	N/A	N/A	N/A	64
New York I**	30' x 30'	900	10'	30	30	32	50	N/A	N/A	24	40
New York II**	30' x 42'	1260	10'	60	60	40	80	30	24	25	64
206-207	12' x 20'	240	9'	Storage room for conferences -see Sales and Catering Department							
Pool Area						60			60		

*Rooms can be divided - 15' x 30', 450 sq ft

** Column in room- speak to Sales and Catering about obstruction

Terrace Restaurant seats 134
Off Broadway Lounge seats 95-100
Vendors in Foyer - 13
Vendors in N. Hall - 12
Vendors in W. Hall - 9
Freight Elevator 9' x 5' (holds 3200 lbs.)

EQUIPMENT

Piano
(8) risers 6' x 8'
Podiums - (3) tabletops (1) standing
Mics - (1) handheld wireless (1) lavelier (4) corded

(2) LCD Projectors - only one with remote
(1) 52" Big Screen TV
(2) 25" TV's
(3) DVD Players
(6) Easels
(4) Flip carts
(2) Portable screens 6'x8'

Dance Floor 21' x 24'
(4) Portable Bars
(2) Keg coolers
White Boards in all meeting rooms with exception of Empire

(2) Tall A/V carts (2) short A/V carts
(56) Classroom style tables 8' x 18"
(3) 4' x 4' Tables
Ovals - 6' x 5'
Full 8' tables - 8' x 3'
(15) Full 6' tables - 6' x 3'
(2) Speaker Phones
(6) Cocktail tables on order

VENDOR TABLES RENT FOR \$15 per table

No Hospitality Rooms available - if interested we can rent out the Presidential Room for a Hospitality Room - See Sales Department for more information

Copies - \$.10 per copy
Color Copies - \$.25 per copy

Address
6th & Broadway
Bismarck, ND 58501

+1 (701) 255-6000
radisson.com/bismarcknd_downtown

