

rooms dimension ● event capacity

Venue	Dimension		Size		Capacity					
	M	Ft	Sq M	Sq Ft	Reception	Theatre	Banquet	Class room	Board room	U-Shape
The Event Room	15.50 x 9.15	50.26 x 29.70	140	1503	125	125	80	70	45	36
The Pre-Function Area	4.40 x 10.25	13.10 x 33.07	39	425	45	-	-	-	-	-
The Forum	5x8	16.40 X 26.24	40	430	30	50	20	20	22	22-25
The Boardroom	3.85 x 6.25	12.63 x 20.50	24	259	-	-	-	10	10	8
The Meeting Room	3.65 x 3.95	11.97 x 12.95	14	155	-	-	-	-	6	-

Theatre Style

Classroom Style

Boardroom Style

U-Shape Style

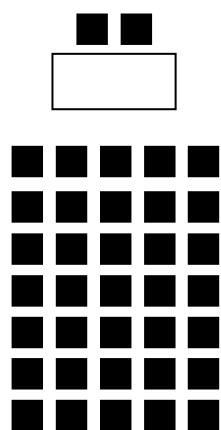

- Ideal for presentations and demonstrations
- Suitable for Q&A sessions but unsuitable for discussions
- Effective for events at which the audience watches and listens but does not take notes

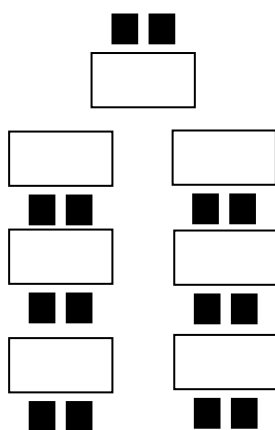

- Effective for participants who want to watch, listen and take notes
- Ideal constellation for listening – but less for discussions
- Good view of the presentation and the speaker

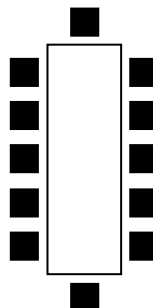

- Effective for events at which the participants need to see one another
- Convenient individual means of communication (intercoms, hands free equipment, etc.)
- Plenty of space for each participant

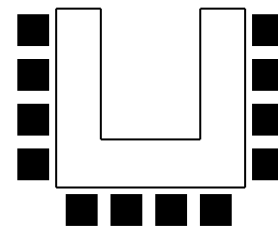

- Ideal for group discussions, teamwork and training sessions
- Possibilities for presentations and demonstrations
- Also suitable for formal events, festive occasions and banquets

Radisson Suites Bangkok Sukhumvit
 23/2 Sukhumvit 13, Sukhumvit Road,
 Klongtoey Nua, Wattana,
 Bangkok 10110, Thailand
 Telephone: +66 (0) 2 645 4999 Fax: +66 (0) 2 645 4888
www.radisson.com/bangkokth_sukhumvit

floor layout ● access

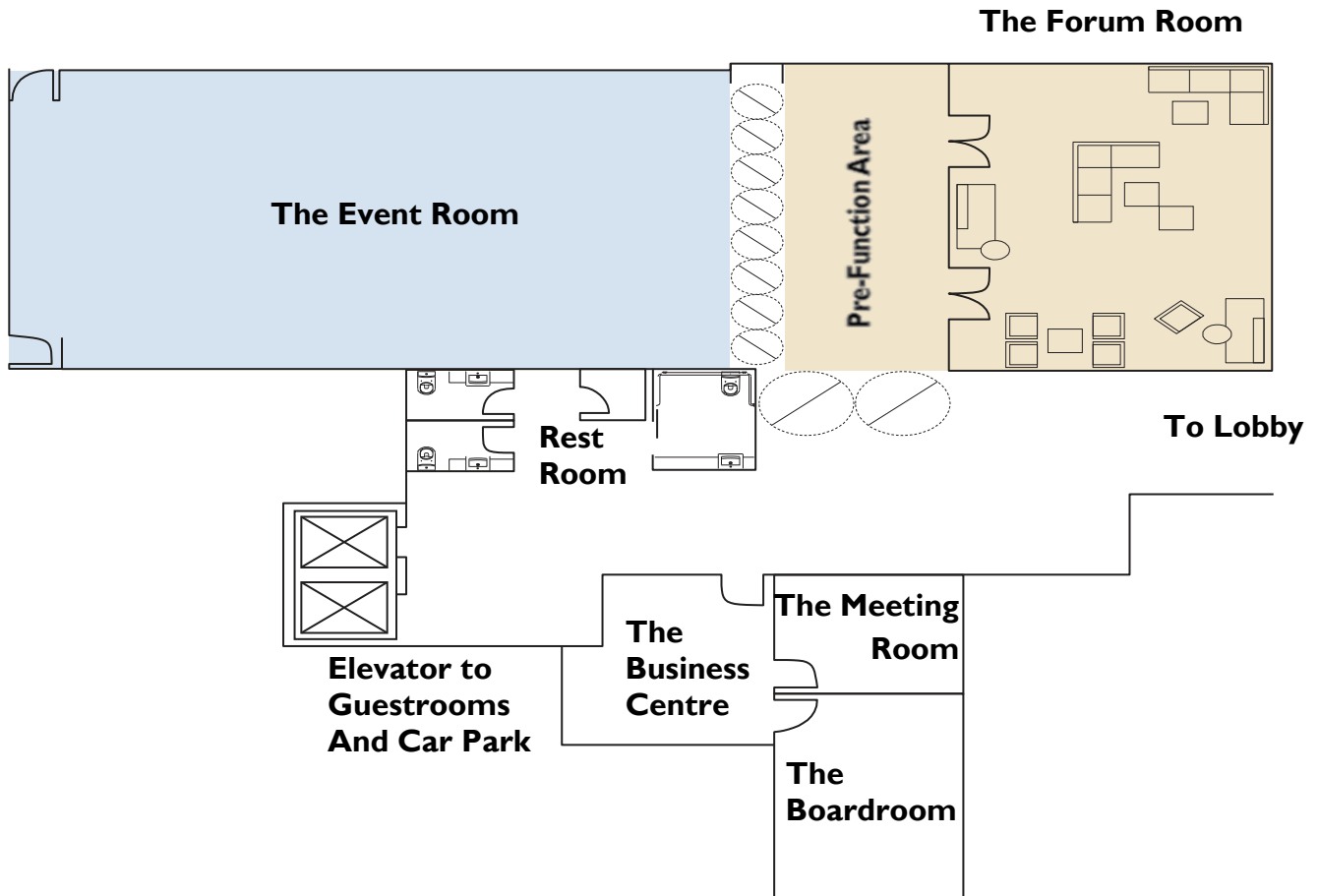

Please note: This drawing furnished for information only, it is not to scale ratio.

Radisson Suites Bangkok Sukhumvit
23/2 Sukhumvit 13, Sukhumvit Road,
Klongtoey Nua, Wattana,
Bangkok 10110, Thailand
Telephone: +66 (0) 2 645 4999 Fax: +66 (0) 2 645 4888
www.radisson.com/bangkokth_sukhumvit

